

73001064

Form 10-300
(July 1959)

UNITED STATES DEPARTMENT OF THE INTERIOR
NATIONAL PARK SERVICE

NATIONAL REGISTER OF HISTORIC PLACES
INVENTORY - NOMINATION FORM

(Type all entries - complete applicable sections)

STATE: NEBRASKA	
COUNTY: HALL	
FOR NPS USE ONLY	
ENTRY NUMBER	DATE
1-16-73	

1. NAME
COMMON:
GRAND ISLAND FCC MONITORING STATION 4L00-1
AND/OR HISTORIC:

2. LOCATION
STREET AND NUMBER:
5 MILES WEST OF GRAND ISLAND NEAR STATE SPUR 430
CITY OR TOWN:
GRAND ISLAND
STATE: NEBRASKA CODE: 68801 COUNTY: HALL CODE:

3. CLASSIFICATION

CATEGORY (Check One)	OWNERSHIP	STATUS	ACCESSIBLE TO THE PUBLIC
<input type="checkbox"/> District <input checked="" type="checkbox"/> Site <input type="checkbox"/> Building <input type="checkbox"/> Structure <input type="checkbox"/> Object	<input type="checkbox"/> Public <input type="checkbox"/> Private <input type="checkbox"/> Both U.S. GOV'T.	<input checked="" type="checkbox"/> Occupied <input type="checkbox"/> Unoccupied <input type="checkbox"/> Preservation work in progress	Yes: <input type="checkbox"/> Restricted <input type="checkbox"/> Unrestricted <input checked="" type="checkbox"/> No
PRESENT USE (Check One or More as Appropriate)			
<input type="checkbox"/> Agricultural <input type="checkbox"/> Commercial <input type="checkbox"/> Educational <input type="checkbox"/> Entertainment	<input checked="" type="checkbox"/> Government <input type="checkbox"/> Industrial <input type="checkbox"/> Military <input type="checkbox"/> Museum	<input type="checkbox"/> Park <input type="checkbox"/> Private Residence <input type="checkbox"/> Religious <input type="checkbox"/> Scientific	<input type="checkbox"/> Transportation <input type="checkbox"/> Other (Specify) <input type="checkbox"/> Comments

4. OWNER OF PROPERTY
OWNER'S NAME:
FEDERAL COMMUNICATIONS COMMISSION
STREET AND NUMBER:
P.O. BOX 1588
CITY OR TOWN:
GRAND ISLAND STATE: NEBRASKA CODE: 68801

5. LOCATION OF LEGAL DESCRIPTION
COURTHOUSE, REGISTRY OF DEEDS, ETC:
OFFICE OF REGISTER OF DEEDS, HALL COUNTY COURTHOUSE
STREET AND NUMBER:
LOCUST AND FIRST STREETS
CITY OR TOWN:
GRAND ISLAND STATE: NEBRASKA CODE: 68801

6. REPRESENTATION IN EXISTING SURVEYS
TITLE OF SURVEY:
NONE OF RECORD
DATE OF SURVEY:
 Federal State County Local
DEPOSITORY FOR SURVEY RECORDS:
STREET AND NUMBER:
CITY OR TOWN:
STATE:
CODE:

SEE INSTRUCTIONS

STATE:

COUNTY:

FOR NPS USE ONLY
ENTRY NUMBER
DATE

7. DESCRIPTION

CONDITION	(Check One)					
	<input checked="" type="checkbox"/> Excellent	<input type="checkbox"/> Good	<input type="checkbox"/> Fair	<input type="checkbox"/> Deteriorated	<input type="checkbox"/> Ruins	<input type="checkbox"/> Unexposed
	(Check One)			(Check One)		
	<input type="checkbox"/> Altered	<input checked="" type="checkbox"/> Unaltered	<input type="checkbox"/> Moved	<input checked="" type="checkbox"/> Original Site		

DESCRIBE THE PRESENT AND ORIGINAL (if known) PHYSICAL APPEARANCE

FCC Monitoring Station consisting of 200 total acres in one parcel with one large two-story unpainted brick and asphalt-shingled building with detached garage of similar construction, with smaller auxiliary buildings nearby. The original monitoring room contained 2000 square feet of floor space, and rooms for dormitories, kitchen, workshop, storage batteries, motor generator and switchboards were provided. This building was constructed from plans and specifications prepared by the Navy Department, Bureau of Yards and Docks with the ground breaking in October 1929. The original site comprised 50 acres and was the first monitoring station constructed for the exclusive use of the predecessor of the Federal Communications Commission, namely, the Federal Radio Commission which was authorized in an act approved February 23, 1927.

SEE INSTRUCTIONS

8. SIGNIFICANCE

PERIOD (Check One or More as Appropriate)

- Pre-Columbian; 16th Century; 18th Century 20th Century
 15th Century 17th Century 19th Century

SPECIFIC DATE(S) (If Applicable and Known)

AREAS OF SIGNIFICANCE (Check One or More as Appropriate)

- | | | | |
|----------------------------------------------------|---------------------------------------|-----------------------------------------|------------------------------------------|
| <input type="checkbox"/> Aboriginal | <input type="checkbox"/> Education | <input type="checkbox"/> Political | <input type="checkbox"/> Urban Planning |
| <input type="checkbox"/> Prehistoric | <input type="checkbox"/> Engineering | <input type="checkbox"/> Religion/Phi- | <input type="checkbox"/> Other (Specify) |
| <input type="checkbox"/> Historic | <input type="checkbox"/> Industry | losophy | _____ |
| <input type="checkbox"/> Agriculture | <input type="checkbox"/> Invention | <input type="checkbox"/> Science | _____ |
| <input type="checkbox"/> Architecture | <input type="checkbox"/> Landscape | <input type="checkbox"/> Sculpture | _____ |
| <input type="checkbox"/> Art | <input type="checkbox"/> Architecture | <input type="checkbox"/> Social/Human- | _____ |
| <input type="checkbox"/> Commerce | <input type="checkbox"/> Literature | itarian | _____ |
| <input checked="" type="checkbox"/> Communications | <input type="checkbox"/> Military | <input type="checkbox"/> Theater | _____ |
| <input type="checkbox"/> Conservation | <input type="checkbox"/> Music | <input type="checkbox"/> Transportation | _____ |

STATEMENT OF SIGNIFICANCE

First United States Radio Monitoring Station and site. Construction completed in 1930 near the geographical center of the 48 contiguous states. Transferred to the FCC by passage of the Communications Act of 1934 as part of President Roosevelt's "New Deal". At the time of the construction of this building there were nine radio district headquarters in various parts of the United States. At the present time there are 24 radio districts and 19 monitoring stations. In July 1911 there were two radio inspectors, one in New York and one in San Francisco, who were responsible for the inspection of ship radio installations. These original two inspectors have increased until, at the present time, there are approximately 420 employees of the Field Engineering Bureau who are concerned with the various aspects of monitoring. Frequency coverage in 1927 extended from 10 to 30,000 kHz, in contrast to the frequency range today to more than 30,000,000 kHz. The latest figures in the Annual Report to Congress issued by the FCC shows that there are more than 7,948 broadcast stations (radio and TV), 1,745,709 stations (using 8,858,222 licensed transmitters) in the Safety and Special Radio Services, 2,523 CATV systems in addition to the telephone and telegraph facilities which are under the jurisdiction of the Commission. In the past 20 years it is estimated that transmitters in operation have increased more than 50 times.

S E E I N S T R U C T I O N S

9. MAJOR BIBLIOGRAPHICAL REFERENCES

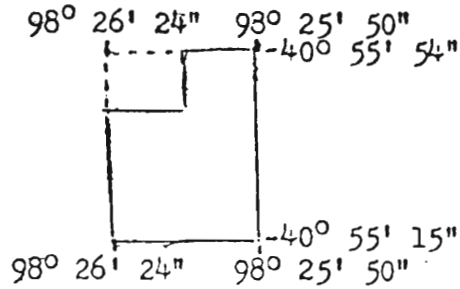

10. GEOGRAPHICAL DATA

LATITUDE AND LONGITUDE COORDINATES DEFINING A RECTANGLE LOCATING THE PROPERTY			O R	LATITUDE AND LONGITUDE COORDINATES DEFINING THE CENTER POINT OF A PROPERTY OF LESS THAN TEN ACRES		
CORNER	LATITUDE	LONGITUDE		LATITUDE	LONGITUDE	
	Degrees Minutes Seconds	Degrees Minutes Seconds		Degrees Minutes Seconds	Degrees Minutes Seconds	
NW	° ' "	° ' "		° ' "	° ' "	
NE	° ' "	° ' "		° ' "	° ' "	
SE	° ' "	° ' "		° ' "	° ' "	
SW	° ' "	° ' "		° ' "	° ' "	

APPROXIMATE ACREAGE OF NOMINATED PROPERTY:

LIST ALL STATES AND COUNTIES FOR PROPERTIES OVERLAPPING STATE OR COUNTY BOUNDARIES

STATE:	CODE	COUNTY	CODE
NA			
STATE:	CODE	COUNTY:	CODE
STATE:	CODE	COUNTY:	CODE
STATE:	CODE	COUNTY:	CODE

11. FORM PREPARED BY

NAME AND TITLE:
HOBART W. JOHNSON, CHIEF, ENGINEERING AND FACILITIES DIVISION

ORGANIZATION: **FCC FIELD ENGINEERING BUREAU** DATE: **June 13, 1972**

STREET AND NUMBER:
ROOM 738 1919 M St., N.W.

CITY OR TOWN: **WASHINGTON** STATE: **D.C.** CODE: **20554**

12. STATE LIAISON OFFICER CERTIFICATION

NATIONAL REGISTER VERIFICATION

As the designated State Liaison Officer for the National Historic Preservation Act of 1966 (Public Law 89-665), I hereby nominate this property for inclusion in the National Register and certify that it has been evaluated according to the criteria and procedures set forth by the National Park Service. The recommended level of significance of this nomination is:

National State Local

Name _____

Title _____

Date _____

I hereby certify that this property is included in the National Register.

 Chief, Office of Archeology and Historic Preservation

Date _____

ATTEST:

 Keeper of The National Register

Date _____

SEE INSTRUCTIONS

